

Ball valve for gas

with sheet steel hand lever or T-handle
high temperature range 650 °C, 30 min
Standard sheet for **2300**, issue 0209

Dimensions

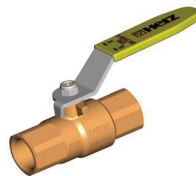

1 2300 0x

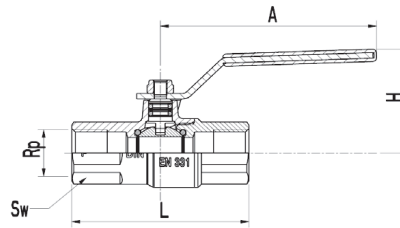

1 2300 1x

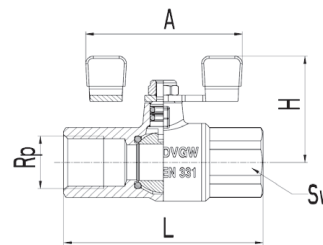

Order number	Operating pressure	PN	DN	Rp	L	H	A/B	Connection torque (Nm)	Width across flats	Weight kg
1 2300 09	5	1	8	1/4	55	41	70	20	17	0.145
1 2300 19							60			
1 2300 00	5	1	10	3/8	60	41	70	35	21	0.180
1 2300 10							60			
1 2300 01	5	1	15	1/2	75	43	90	75	26	0.275
1 2300 11							60			
1 2300 02	5	1	20	3/4	80	47	90	100	32	0.395
1 2300 12							60			
1 2300 03	5	1	25	1	90	61	135	125	41	0.725
1 2300 13							85			
1 2300 04	5	1	32	1 1/4	110	66	135	160	50	1.175
1 2300 14							85			
1 2300 05	5	1	40	1 1/2	120	86	180	200	55	1.830
1 2300 06	5	1	50	2	140	90	180	250	70	3.000

Version

- Body: brass as per EN 12165
- Ball: forged brass, full opening, machine-polished and chrome-plated
- Spindle: brass
- Hand lever: sheet steel with plastic cover
- Thread: female thread according to ISO 7-1 (DIN 2999, BS 21)
- Seals: NBR, 80 Shore for ball, NBR 70 Shore for spindle

Technical data

- Maximum operating pressure: MOP 5 (EN 331), PN 1 (high temperature range 650 °C)
- Maximum operating temperature: -20 °C to 60 °C
- Application: for gases of gas families 1, 2, 3 according to EN 437 (DVGW table G 260/1)

Application

The ball valve is used as an "OPEN/CLOSED" type isolating valve with gas installations as per DVGW-TRGI, G 260/I. Areas of application include gas-fired heating systems, water heaters upstream of the consumer. In the case of a fire the seal will burn down due to the high fire temperature. In this case, the sealing between ball and body using is ensured by the remaining metal seal. At a temperature of 650 °C the valve remains closed for 30 minutes. The ball valve is used as a safety valve in gas installations.

Installation

For the threaded connection commercially available sealing materials such as hemp fiber and sealing compound or Teflon tapes are used. The indicated maximum connection torque must not be exceeded when screwing in the pipe ends. The ball valve is positioned upstream of the consumers as a means of fire protection. We recommend to exclusively use the ball valve either in the fully opened or fully closed position, never in intermediate positions. The ball valve is maintenance-free, however, it is recommended to operate it 2 times a year.