

HERZ - Ball valve

with extended spindle DZR

 Data sheet 1 **2190 2X**

☑ Dimensions

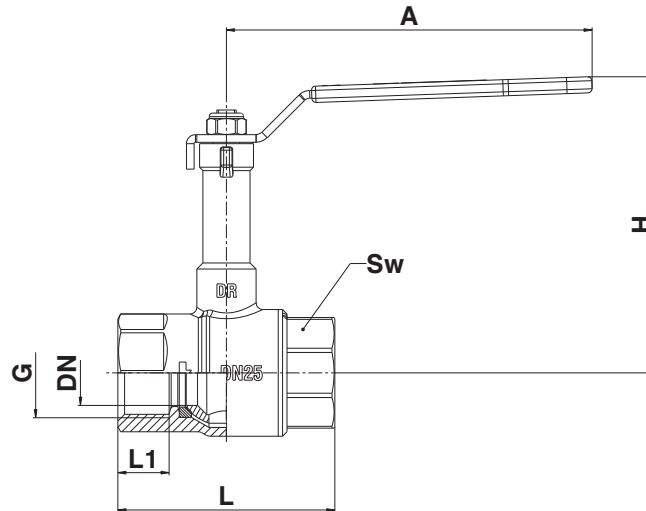

Order Nr.	DN	G [in]	L [mm]	L1 [mm]	H [mm]	A [mm]	Sw [mm]	Weight [kg]
1 2190 21	15	1/2"	59	15	90	90	25	0,28
1 2190 22	20	3/4"	64	16	93	90	32	0,40
1 2190 23	25	1"	80,5	19	107	135	41	0,74
1 2190 24	32	1-1/4"	91	19,5	111	135	48	0,96
1 2190 25	40	1-1/2"	100	19,7	136	180	55	1,38
1 2190 26	50	2"	118	22,3	144	180	69	2,52

☑ Material and construction

Body:	forged brass acc. to EN 12165, nickel plated, CW602N DZR
Ball:	forged brass acc. to EN 12165, hollow, full bore, hard chrome plated, CW602N, DZR
Spindle:	machined brass acc. to EN 12164, CW614N
Handle:	lever handle, red, sheet steel - plated
Ball seals:	PTFE
Spindle seals:	EPDM
Internal threaded connectors:	acc. to ISO 228

☑ Operating data

Max. operating pressure:	PN 25 bar
Min. operating temperature:	-10°C (water 0,5°C)
Min. short-term temperature load:	-50°C
Max. operating temperature:	130°C (water 110°C-no steam)
Max. short-term temperature load:	150°C
Medium:	

Heating water quality according to ÖNORM H5195 or VDI-Standard 2035. The use of ethylene or propylene glycol in a mixing ratio 25- 50% is allowed. Please refer to manufacturers documentation when using ethylene glycol products for frost and corrosion protection. Please note that EPDM gaskets will be affected by Mineral oils lubricants and thus lead to failure of the EPDM seals in the valves that use EPDM seals. HERZ ball valve for heating and chilled water is not suitable for usage of aggressive medium (such as: acids, alkalis, combustible and explosive gases..) because it can destroy sealing components.

☑ Field of application

HERZ ball valve with extended spindle DZR is designed for building services such as heating or chilled water plants. The operating conditions (temperature, pressure) should be constant. Extended spindle allows easy installation of thicker insulation. The handle is isolated separately so that the valve can be opened and closed without breaking or damaging the insulation. HERZ ball valve with extended spindle DZR is made from CW602N; this material has DZR properties (dezincification resistant brass). The ball valve is bi-directional, that means it allows flow of the medium in both directions.

☑ Additional informations

For further informations about the field of application, brass, function principle, assembly, maintenance and disposal instructions see chapter "General information" on page 2.

☑ Labels on ball valve

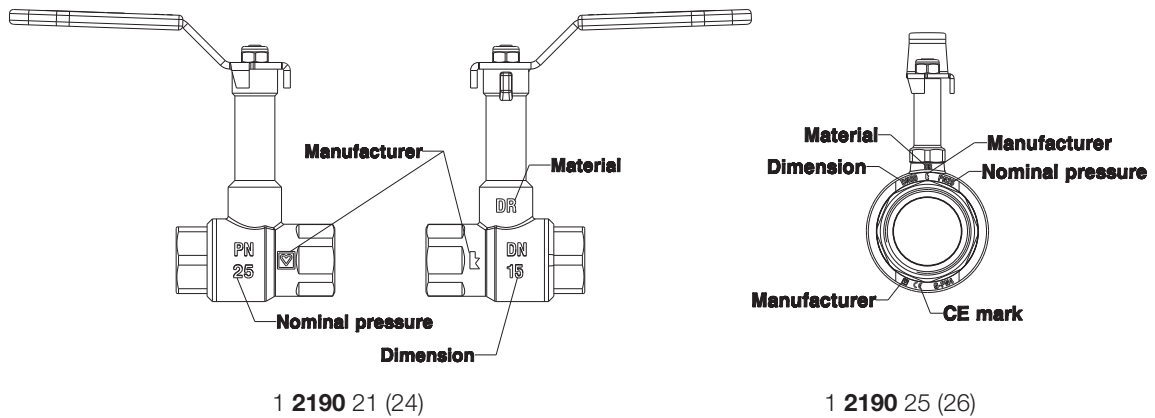



HERZ - BALL VALVE

with compression ends

Datasheet 1 2190 4X (6X)

☑ Dimensions

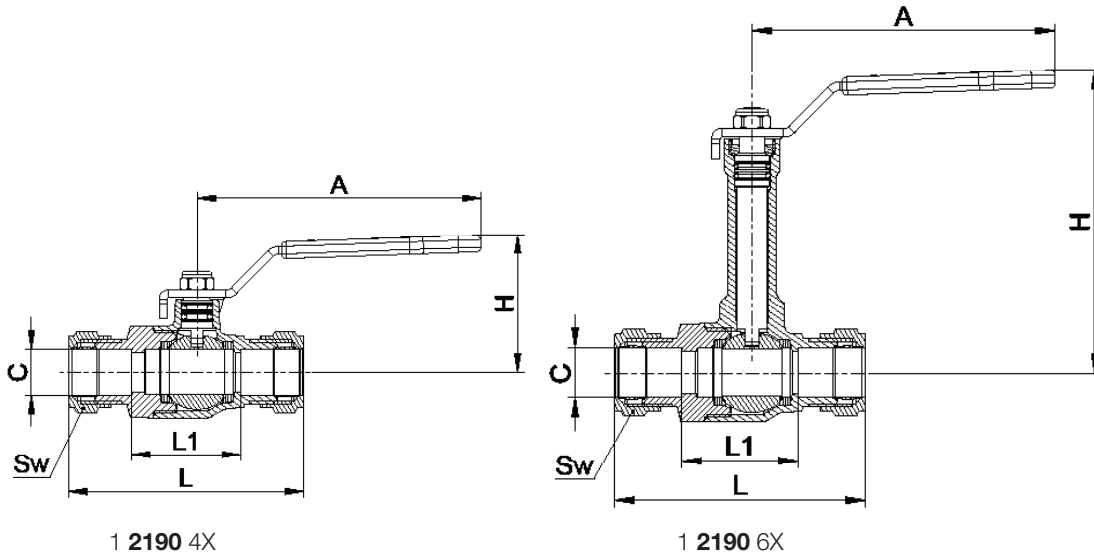

Model	DN	PN [bar]	Cu	C [mm]	L [mm]	L1 [mm]	H [mm]	A [mm]	Sw
1 2190 41	15	16	15	15,2	76,5	35,5	47	90	24
1 2190 42	20	16	22	22,2	81	37	49	90	32
1 2190 43	25	16	28	28,1	95	44,4	61	135	37
1 2190 44	32	16	35	35,1	108,5	54,6	65	135	46
1 2190 45	40	16	42	42,2	122	60	84	180	60
1 2190 46	50	16	54	54,4	134	72	90	180	70
1 2190 61	15	16	15	15,2	76,5	35,5	94	90	24
1 2190 62	20	16	22	22,2	81	37	97	90	32
1 2190 63	25	16	28	28,1	95	44,4	110	135	37
1 2190 64	32	16	35	35,1	108,5	54,6	114	135	46
1 2190 65	40	16	42	42,2	122	60	135	180	60
1 2190 66	50	16	54	54,4	134	72	142	180	70

☑ Material and construction

Body:	forged brass acc. to EN 12165, CW602N, DZR
Ball:	forged brass acc. to EN 12165, hollow, full bore hard chrome plated, CW602N, DZR
Spindle:	machined brass acc. to EN 12164, CW614N
Handles:	lever handle, red, sheet steel - plated
Ball seals:	PTFE
Spindle seals:	EPDM

☑ Operating data

Maximum pressure:	16 bar (20 °C)
Temperature range:	120 °C (5 bar)
Construction and tests:	WRAS approved

☑ Field of application

HERZ – ball valve with compression ends is designed for easy and fast installation of the valve in the pipe network. It is suitable for heating and chilled water systems where the pipes are made from copper, carbon steel and stainless steel. Tightening pipe connection system is made from components that allow quick installation without special tools and sealing materials. It enables effective seal and easy adjustment of the position of the ball valve in the pipe network.

☑ Instruction for assembling and maintenance

Ensure that the tube has been cut straight and deburred properly leaving no sharp edges. Insert the tube firmly into the compression fitting, ensuring that the compression ring seats centrally and that the tube makes firm contact in the bottom of the valve housing.

Hand tighten the nut then, using a suitable spanner, further tighten a 3/4 turn (270°) for sizes 15mm to 42mm and one full turn for 54mm, ensuring the valve body is secured with a suitable tool. A light oil can be used on the threads to assist tightening. If sealant paste is required, use a suitable WRAS approved PTFE based compound.

☑ Additional informations

For further informations about the field of application, brass, function principle, assembly, maintenance and disposal instructions see chapter "General information" on page 2.

☑ Labels on ball valves