

Ball Check Valve

PN10/PN16

Fig. 5109



Valve Standard:

Face to face standard conforms to DIN-6

Flange connection conforms to BS EN1092-2 PN10/PN16

Pressure Temperature Ratings

Working pressure	10bar / 16bar
Testing Pressure	Shell: 15bar / 24bar
	Seal: 11bar / 17.6bar

Material Specification

Part	Material	Specification
Body	Ductile Iron	GGG50
Ball	Carbon Steel/Iron + EPDM	-
Bonnet	Ductile Iron	GGG50
Gasket	EPDM/NBR	-
Bolt	Steel	C45E/1045

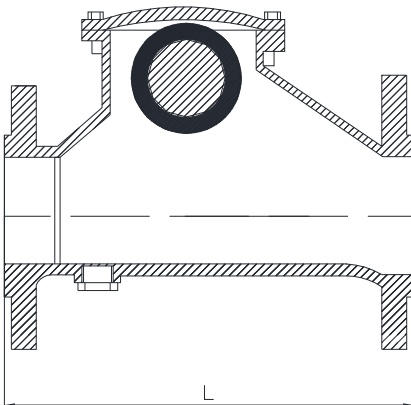

Dimensions (mm)

DN	mm	50	65	80	100	125	150	200	250	300
	inch	2	2-1/2	3	4	5	6	8	10	12
L		200	240	260	300	350	400	500	600	700

Note: Information listed might be subject to change without notice due to continuing products development.